

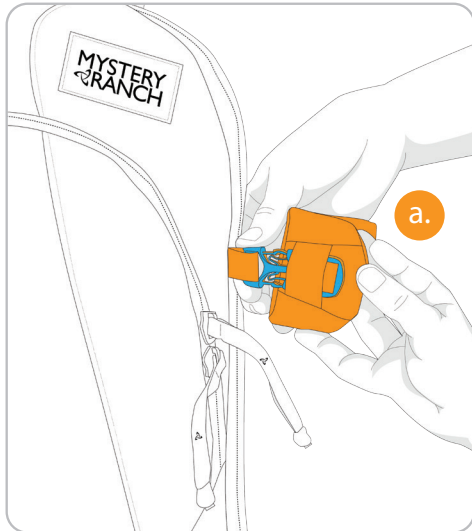

ATTACHING A MYSTERY RANCH SNOWBOARD ATTACH TO OUR PACKS:



1. Remove buckles and web keepers off of all four compression straps.

2. Connect a snowboard attach to the hard mounted buckle on the pack as in the image on the left. There are Female Snowboard Attach for the right side, and Male Attach for the left. (fig. a)

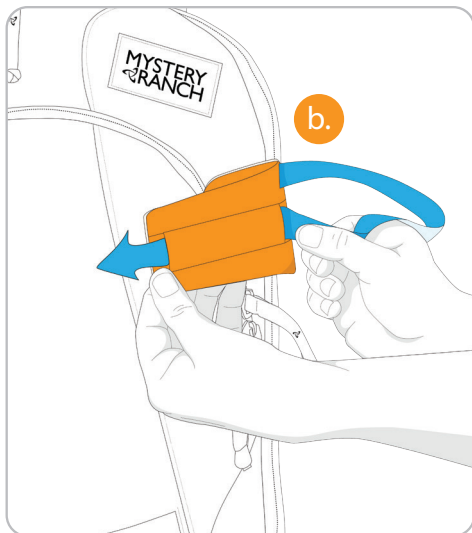

3. Thread the compression through the sleeve on the Snowboard Attach. (fig. b)

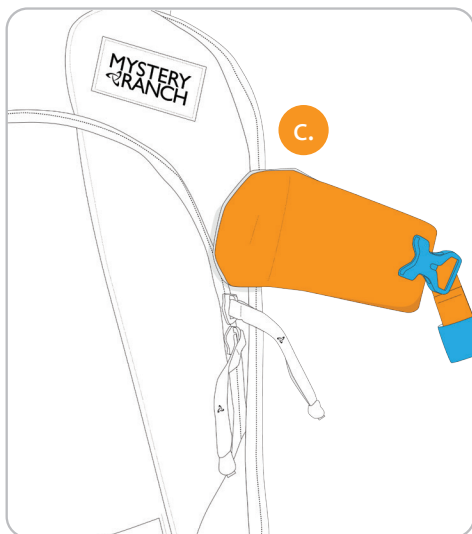

4. Replace the Buckle and Web keeper that you removed in step one. (fig. c)

5. Repeat this process on all four compression straps.

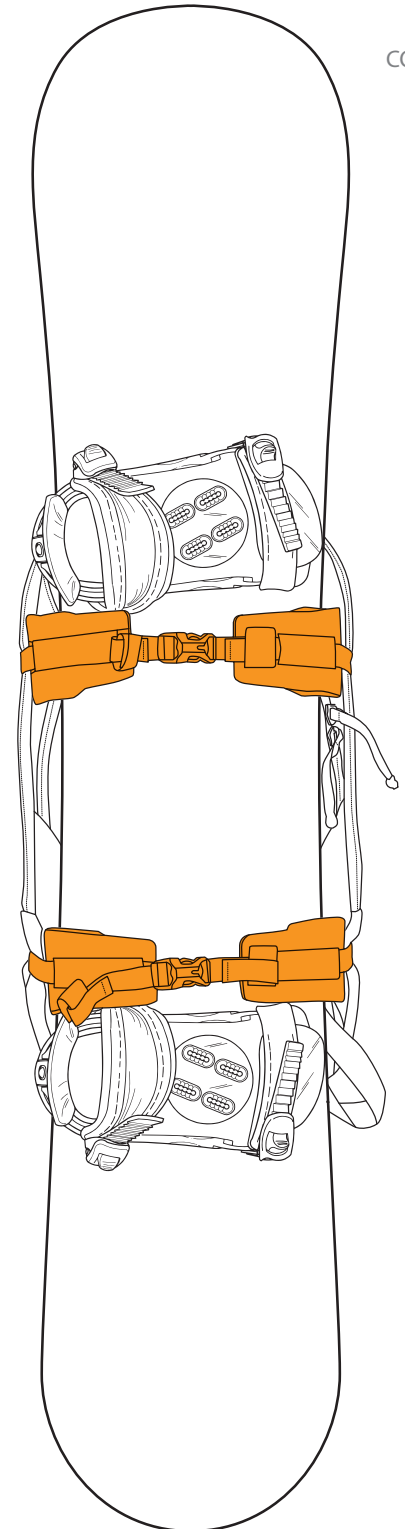

COMPLETE VIEW