

FLIPOUT™

HANDLE + STAND INSTALLATION INSTRUCTIONS

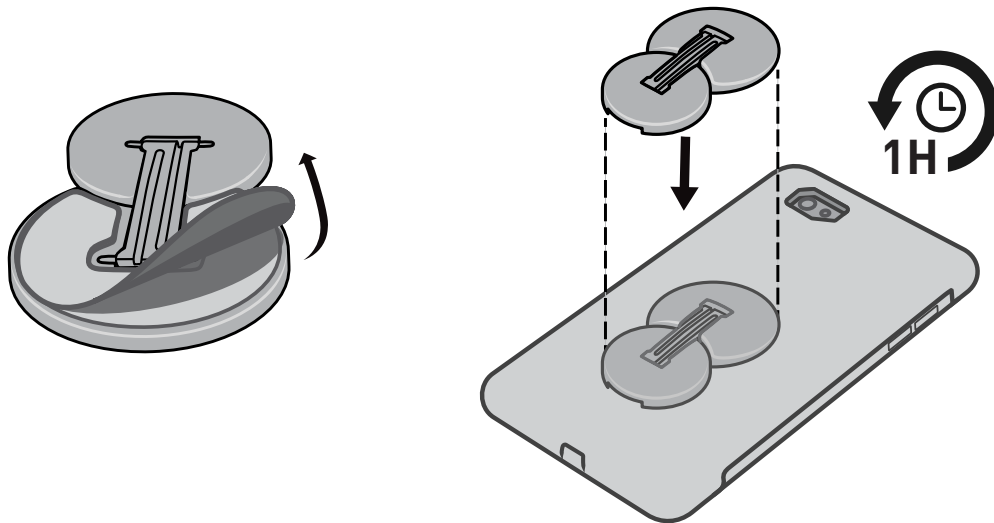

FOR BEST RESULTS: CLEAN BACK OF PHONE OR CASE WITH ALCOHOL BEFORE ATTACHING THE FLIPOUT TO PHONE.

PEEL ADHESIVE BACKING FROM FLIPOUT AND ATTACH TO THE PHONE OR CASE USING MULTISTICK™ ADHESIVE. TO REMOVE OR REPOSITION FLIPOUT, PEEL UP SLOWLY. REPOSITION IMMEDIATELY OR ATTACH TO CLEAN, SMOOTH HARD SURFACE BY PRESSING FIRMLY. FLIPOUT CAN BE USED IMMEDIATELY, HOWEVER ADHESIVE TAKES 1 HOUR TO REACH FULL STRENGTH.

IF MULTISTICK ADHESIVE LOSES ITS STICKINESS, IT CAN BE REACTIVATED. TO REACTIVATE MULTISTICK ADHESIVE, WASH WITH SOAP AND WATER AND AIR DRY. MULTISTICK ADHESIVE SHOULDN'T BE EXPOSED TO AIR FOR MORE THAN 15 MINUTES OR IT MAY DRY OUT PERMANENTLY.

DO NOT USE THIS PRODUCT ON SOFT, FLEXIBLE, OR HIGHLY TEXTURED CASES.

HARDSHELL CASE REQUIRED FOR GLASS-BACKED PHONES.